

Honeywell

6W Solar Fan Owner's Manual

527HHON001BLK



READ AND SAVE THESE INSTRUCTIONS

If you have any problems with this unit please call customer service toll free: 1-800-459-4409
Do not return the unit to the store before calling customer service.

IMPORTANT SAFEGUARDS

Install on a shingled, pitched roof only. Consult your local building code to determine required and or correct attic ventilation for your application.

Read all instructions and warnings completely before installation.

Professional installation is recommended for original installation.

WARNING

- This product has sharp metal edges that can cut your hands. Wear gloves while handling the fan during installation.
- Install at your own risk! Installation requires climbing and working at dangerous heights, including on ladders, scaffolding, roofs and in attic spaces. Risk of death, personal injury and property damage may result from a fall, or from falling objects.
- Use extreme caution to minimize risk of accidental injury, including, but not limited to the following procedures:
- Avoid working on surfaces that are slippery or wet.
- Use foot-wear with excellent traction.
- Use only strong, well supported ladders.
- Work only in calm dry weather.
- When in an attic, ensure that your weight is supported at all times with structurally sound framing; dry wall material is not designed to carry a person's weight.
- To reduce the risk of fire, electric shock, and personal injury; basic safety precautions should always be followed when using electric tools, including always wearing safety goggles or other suitable eye protection, and ensuring work area is clear of all electrical wires, gas pipes, water pipes, and other obstacles.
- When working in an attic, use of a mask or respirator is recommended to avoid lung irritation. Attic spaces may be dark, confined, and subject to extreme temperatures. Beware of sharp protruding objects. Do not attempt installation without having someone within range of your voice or close enough to come to your aid if necessary.

Quality Craft warrants this product to be free from defects in materials and manufacturer's workmanship for a period of 5 years on the motor and 20 years on the solar panel and housing, from the date of purchase. Proof of purchase is required for all claims. This warranty is subject to proper use and installation as specified in this manual. The company's sole obligation is to repair or replace the unit.

If the unit should fail to operate within your warranty period please contact customer service at: 1-800-459-4409 (EST) or through our website at: www.qualitycraft.com.

This warranty is void if in the opinion of Quality Craft, the unit has been tampered with, altered, misused, damaged, abused or not used as intended. The warranty is for homeowner use only and does not cover units used in commercial situations. The manufacturer will not be liable for any special, incidental or consequential damages in any way related to, or arising out of, defects in, or damage to, the solar attic fan.

This warranty gives you specific legal rights, and you may have other rights which vary from state to state concerning exclusion or limitation of incidental or consequential damages.

SPECIFICATIONS

- Ventilates roof area up to 450 sq. ft.
- Motor: 24 Volt
- Solar panel: 6 W
- Material: Galvanized and powder coated metal components

PARTS, TOOLS & SUPPLIES

PARTS

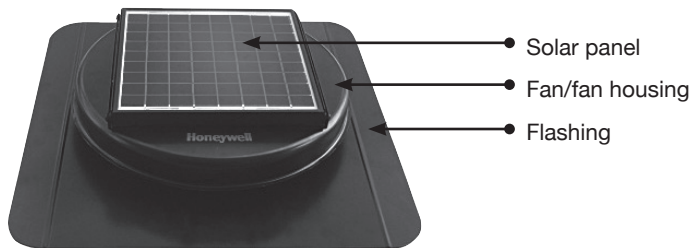

TOOLS REQUIRED

- Safety glasses
- Work gloves
- Extension ladder
- Permanent marker
- Utility knife
- Tape measure
- Hammer
- Screw driver
- Drill (1/2" drill bit)
- Reciprocating or jig saw
- Caulking gun

SUPPLIES REQUIRED

- Silicone or waterproof roofing sealant
- Four (4) self tapping screws or nails

LOCATION

1. Solar fans get 100% of their operational power from the sun, therefore the solar panel needs to be exposed to as much sunlight as possible. South exposure is best. If a southern exposure is not possible, look for another sunny exposure for your installation. The solar panel can also be adjusted to capture maximum available sunlight.

Avoid potential problems such as trees and other buildings shading the unit during certain times of the day. Avoid installing near a wall, chimney or any building section that is positioned higher than the solar fan. There should be a minimum of 48" between the solar fan and any possible obstruction.

ORIGINAL INSTALLATION

2. From inside the attic, measure down from the roof peak 24" and mark a spot centered between two rafters. Drill a 3" screw through this point into the plywood and roof shingle so it will be visible when you are on the roof. If you are installing multiple fans - be sure to separate fans by at least a distance of 10 ft.

Once on the roof, locate the screw and attach a string to it. Attach a pen to the other end of the string and adjust the string length to 3". Mark a 6" diameter circle onto the roof shingles. **IMPORTANT: THE SOLAR FAN MUST BE INSTALLED BETWEEN THE ROOF RAFTERS. DO NOT CUT THROUGH ANY ROOF RAFTERS.**

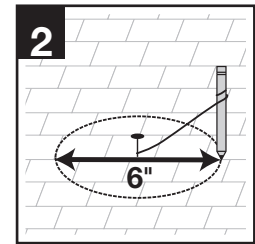
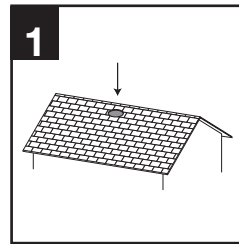

3. Using a power drill equipped with a 1/2" drill bit make a pilot hole on the circle. Then using a reciprocating saw, cut the hole. Use a hammer to clear away any remaining pieces of wood and shingle from the hole after cutting. **NEVER CUT THROUGH ANY ROOF RAFTERS. REMOVE ONLY ROOF SHEATHING.**
4. With a utility knife, cut away the shingles an additional 2 inches around the 6 inch hole you have cut. Remove any nails and staples from this area so flashing will be able to slide into position easily.

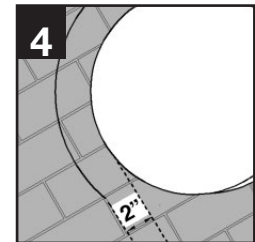
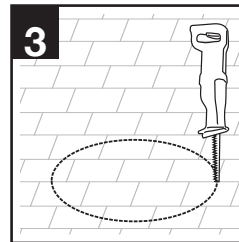

5. You will need to cut or remove the roofing nails located 5" above and to each side of the hole to make room for the flashing to slide between the felt paper and the shingles. Insert the reciprocating saw blade sideways into one of the slits cut previously, then cut up and around the entire area that will be covered by the footprint of the upper half of the flashing.
6. Apply a continuous bead of roof sealant to the underside perimeter of the solar fan.

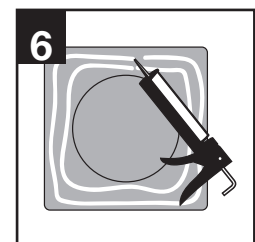
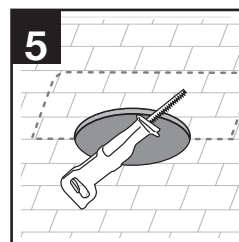

7. Turn the solar fan right side up and slide the flashing marked "UP" through the slits you cut previously. Push the flashing under the shingles (but over the felt paper) until the fan is centered over the hole. (Do not smear caulk on the exposed shingles). The lower part of the flashing should sit on top of the roof shingles.
8. Using 4 roofing nails, secure the solar fan to the roof. The solar fan should be secured across the bottom of the flashing.

Apply waterproof roofing sealant to the nail heads. Use more roofing nails as needed to secure any loose shingles. Always apply waterproof roofing sealant to the backside of any loose shingles or nail heads that have been added.

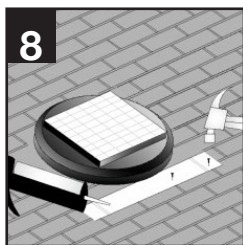
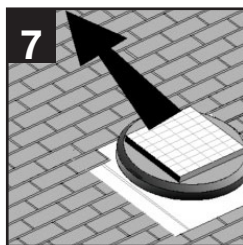

9. Loosen the screw on the clip/screw assembly located on each side of the solar panel bracket. Adjust the solar panel to a position that will collect the most sunlight throughout the day. Tighten screws at the desired position.
10. To ensure water tightness, roofing caulking must be used to seal between all the edges of the base and the roof, especially bottom and side areas of base not covered by shingles.

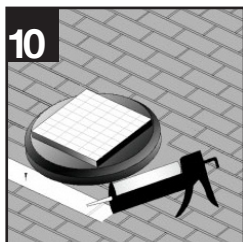
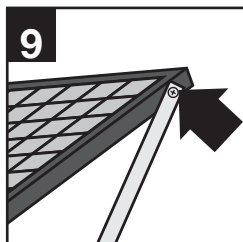

REPLACE AN EXISTING VENT

This solar fan is ideal for replacement of an existing static vent provided the original attic vent has a similarly sized footprint. This product requires a roof opening of 6" diameter. The position of the existing vent also needs to be in a suitable location. Confirm correct location in section 1 of the original installation instructions.

1. Begin by removing the existing attic vent. Pull back any shingles surrounding the base. Save shingles for reuse. Remove any screws or nails that have been used to fasten the attic vent to the roofing substrate. Clean the substrate area of any old cement, caulking or glue or other debris to ensure a tight seal for the new solar attic fan base.
2. After removal as described above, follow the installation instructions starting in section 6.

CLEANING

Clean the surface of the solar panel with soap and water periodically.

Manufactured by

Quality Craft Ltd.

Laval, Quebec

Canada H7S 2G7

www.qualitycraft.com

(800) 459-4409

Made in China

Honeywell

The Honeywell Trademark is under licence from Honeywell International Inc. Honeywell International Inc. makes no representations or warranties with respect to this product.